



CAPT-AIR®

8001 Rue Larrey, Anjou, QC, Canada, H1J 2L4
514-273-4331 • info@capt-air.com • www.capt-air.com



CERTIFIED ROTARY VALVE

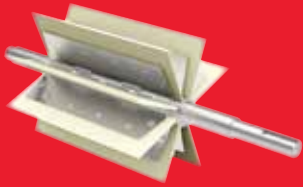

Transitioning the World to a Safer Working Environment

bossproductsamerica.com



Agriculture & Grain



Food and Beverage



Metal Working



Pharmaceutical



Wood Processing



Certified Rotary Valve

Boss Products signed an exclusive North American distribution contract with **VDL Industrial Products** in January 2019. For decades, **VDL Industrial Products** has been providing effective rotary valve solutions for many industries and applications. In addition to the classic styles of rotary valves, **VDL** also offers various innovations as a result of targeted market research and continuous developments from their R&D department. The most notable examples include; diverse explosion-proof designs, explosion certified flex-tip and the MD range for pneumatic conveying.

All rotary valve motors and gearboxes are sourced and inventoried in North America, installed and tested by **Boss Products** at our facility near San Antonio, Texas.

EcoMaxx® / VDL Rotary Valves are :

ATEX Certified, NFPA Compliant
Including Rotary Vales with ATEX tested Flex-Tip

VDL Rotary Valves

Standard Duty (Non ATEX/ NFPA)

EXPLOSION ISOLATION & DIVERSION

Certified Rotary Valve EMVDL-RVEX-HT



04

Certified Rotary Valve EMVDL-RVEX-HTS



05

Certified Rotary Valve EMVDL-RVEX-MD



06

Certified Rotary Valve EMVDL-RVEX-BS



07

Rotary Valve VDL-HTHB (*Heat resistant*)



08

Rotary Valve VDL-HTHBS (*Heat resistant*)



09

Blades and Rotors



10

Accessories



11

Certified Rotary Valve EMVDL-RVEX-HT

APPLICATIONS

- Passive explosive isolation. ATEX EN 15089 / NFPA 69
- Differential pressures up to 40" WG
- Rotary airlock for dust collectors and cyclones
- Feeder valve for screw conveyors, scales, dryers and coolers

CERTIFICATIONS & STANDARDS

EN 15089
 CE 0588 Ex II ID/* c T4 Ex D FSA 15 ATEX 1661/1662 X
 NFPA 69 compliant
 Flex tip design certified to prevent flame passage
 NFPA 69 12.2.4.3.6 compliant



STANDARD FEATURES

- Explosion & Flame Proof design rated up to 25 psi / 1.7 bar
- Cast iron body with flanged round inlet/outlet
- NFPA 69 Compliant with 8 blade rotor, polyurethane flex-tips
- External oil / bronze bearings with felt shaft seal
- 15 RPM direct drive gearmotor with flex coupling, USA Mfg

OPTIONAL FEATURES

- Motors for hazardous locations and extreme temperature
- 30 RPM gearmotor with EM variable speed control package
- Special construction such as stainless steel, chromium or nickel plating, quick disassembly
- Insulation box, speed monitors, flange gasket, injector fittings and product scrapers

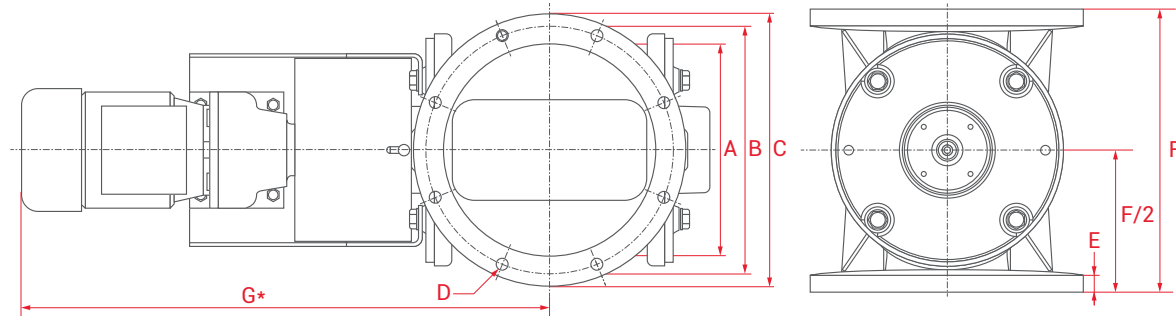

DIMENSIONS*										
MODEL	15 RPM HP	30 RPM HP	CAPACITY FT ³ (LTR)	Ø A	Ø B	Ø C	D	E	F*	G
EMVDL RVEX-HT250	0.33	0.75	0.24 (7)/rev	10" (250 mm)	12" (290 mm)	13" (320 mm)	8 x Ø12 mm	0.79" (20 mm)	13" (330 mm)	24" (620 mm)
EMVDL RVEX-HT350	0.50	1.00	0.70 (20)/rev	14" (340 mm)	15" (390 mm)	17" (420 mm)	8 x Ø12 mm	0.79" (20 mm)	16" (400 mm)	26" (670 mm)
EMVDL RVEX-HT450	1.00	2.00	1.23 (35)/rev	17" (420 mm)	19" (490 mm)	21" (525 mm)	8 x Ø12 mm	0.79" (20 mm)	20" (500 mm)	33" (850 mm)

SQUARE TO ROUND TRANSITIONS*						
SQUARE TRANSITION (Nominal Size Inches)	6X6	8X8	10X10	12X12	14X14	16X16
Model : EMVDL-RVEX	HT250	HT250	HT250	HT350	HT350	HT450
Transition Height	2.84" (72 mm)	2.80" (71 mm)	2.80" (71 mm)	2.80" (71 mm)	2.80" (71 mm)	3.43" (87 mm)
Overall Height (Dim F + Transition Height)	16" (402 mm)	16" (401 mm)	16" (401 mm)	19" (471 mm)	19" (471 mm)	23" (587 mm)

* Length varies dependent on motor selection – Units in inches rounded to the closest whole number

Certified Rotary Valve EMVDL-RVEX-HTS

APPLICATIONS

- Passive explosion isolation, ATEX EN 15089 / NFPA 69
- Rotor selections for dry, corrosive & sticky material
- Tested for high vacuum applications up to 160" WG
- Ideal for dust collectors, cyclones, silos, hoppers & specialized process applications

CERTIFICATIONS & STANDARDS

EN 15089
 CE 0588 Ex II ID/* c T4 Ex D FSA 15 ATEX 1661/1662 X
 NFPA 69 compliant
 Flex tip design certified to prevent flame passage
 NFPA 69 12.2.4.3.6 compliant



STANDARD FEATURES

- Explosion & Flame Proof design rated up to 36 psi / 2.5 bar (25 psi / 1.7 bar with polyurethane flex tip rotor)
- Cast iron body with flanged inlet and outlet
- NFPA Compliant with 8 blade polyurethane flex tip rotor
- NFPA Compliant with 8 blade steel or S/S construction
- Dust tight ball bearings & shaft seal with adjustable packing
- 15 RPM direct drive gearmotor w/flex coupling, IP65, USA mfg

OPTIONAL FEATURES

- Motors for hazardous locations and extreme temperature
- 30 RPM gearmotor with EM variable speed control package
- Square to round flange adapter incl. gasket and mounting bolts
- S/S construction, quick disassembly, and specialized coatings
- Insulation box, speed monitor, injector fittings and scrapers

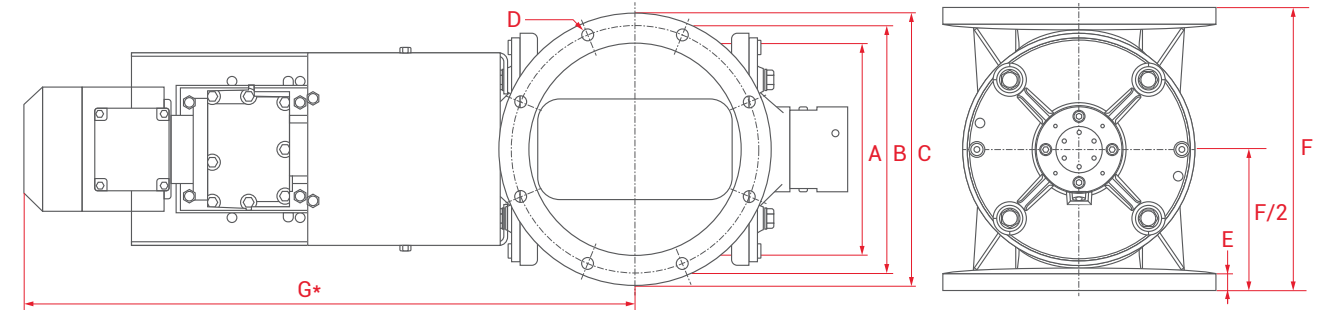

DIMENSIONS*										
MODEL	15 RPM HP	30 RPM HP	CAPACITY FT ³ (LTR)	Ø A	Ø B	Ø C	D	E	F*	G
EMVDL RVEX-HTS250	0.33	0.75	0.24 (7)/rev	10" (250 mm)	12" (290 mm)	13" (320 mm)	8 x Ø12 mm	0.79" (20 mm)	13" (330 mm)	28" (710 mm)
EMVDL RVEX-HTS350	0.50	1.00	0.70 (20)/rev	14" (340 mm)	15" (390 mm)	17" (420 mm)	8 x Ø12 mm	0.79" (20 mm)	16" (400 mm)	33" (830 mm)

SQUARE TO ROUND TRANSITIONS					
SQUARE TRANSITION (Nominal Size Inches)	6X6	8X8	10X10	12X12	14X14
Model : EMVDL-RVEX	HTS250	HTS250	HTS250	HTS350	HTS350
Transition Height	2.84" (72 mm)	2.80" (71 mm)	2.80" (71 mm)	2.80" (71 mm)	2.80" (71 mm)
Overall Height (Dim F + Transition Height)	16" (402 mm)	16" (401 mm)	16" (401 mm)	19" (471 mm)	19" (471 mm)

* Length varies dependent on motor selection – Units in inches rounded to the closest whole number

Certified Rotary Valve EMVDL-RVEX-MD

APPLICATIONS

- Passive explosion isolation requiring rotor access for frequent cleaning
- Differential pressures **up to 400" WG**
- Heavy Duty design, ideal for high vacuum applications
- Recommended for pneumatic conveying of process material and dust feeder valve for screw conveyors, scales, classifiers dryers and coolers

CERTIFICATIONS & STANDARDS

EN 15089
 CE 0588 Ex II ID/* c T4 Ex D FSA 15 ATEX 1661/1662 X
 NFPA 69 compliant
 Flex tip design certified to prevent flame passage
 NFPA 69 12.2.4.3.6 compliant



STANDARD FEATURES

- Explosion & Flame Proof design to **36 psi / 2.5 bar** (25 psi / 1.7 bar with polyurethane flex tip rotor)
- Cast iron housing with round inlet and outlet
- Direct Drive **15 RPM, IP65 gearmotor** w/flex coupling
- Removable 8 vane polyurethane, steel or S/S rotor
- Adjustable Gland Pack bearings for shaft sealing
- High fill ratio with very low leakage & product damage

OPTIONAL FEATURES

- Motors for hazardous locations and extreme temperature
- 30 RPM** gearmotor with EM variable speed control package
- Special construction, stainless steel, chromium/nickel plating
- Insulation box, speed monitors, flange gasket, injector fittings and product scrapers

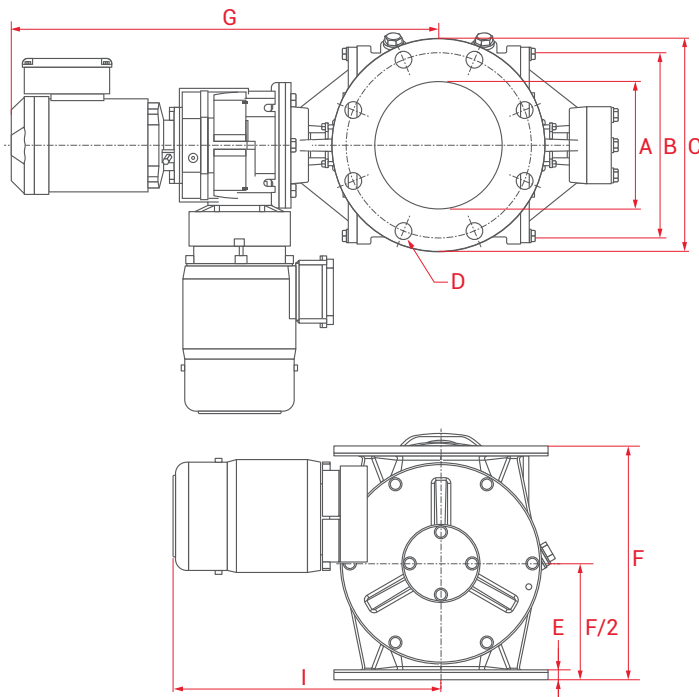

DIMENSIONS *												
MODEL	15 RPM HP	30 RPM HP	CAPACITY FT ³ (LTR)	Ø A	Ø B	Ø C	D	E	F	G	H	I
EMVDL RVEX-MD150	0.50	0.75	0.10 (3)/rev	6" (150 mm)	9" (240 mm)	11" (285 mm)	8 x Ø23 mm	0.51" (13 mm)	10" (260 mm)		13" (330 mm)	14" (355 mm)
EMVDL RVEX-MD200	0.75	1.50	0.39 (11)/rev	8" (200 mm)	12" (300 mm)	13" (340 mm)	8 x Ø23 mm	0.51" (13 mm)	15" (370 mm)		16" (400 mm)	21" (525 mm)
EMVDL RVEX-MD250	1.00	1.00	0.74 (21)/rev	10" (250 mm)	14" (350 mm)	16" (395 mm)	12 x Ø23 mm	0.67" (17 mm)	17" (425 mm)	30" (770 mm)		
EMVDL RVEX-MD300	1.50	3.00	1.30 (37)/rev	12" (300 mm)	16" (400 mm)	18" (445 mm)	12 x Ø23 mm	0.79" (20 mm)	20" (500 mm)	33" (840 mm)		

Columns G, H and I depend on drive

* Units in inches rounded to the closest whole number

Certified Rotary Valve EMVDL-RVEX-BS

APPLICATIONS

- Passive explosion and flame isolation
- Differential pressures **up to 28" WG**
- Ideal for wood applications w/flex-tip rotor
- Rotary airlock for dust collectors and cyclones

CERTIFICATIONS & STANDARDS

ATEX 1D/2D T4 safety system
 CE 0588 Ex II 1D/2D T4 (Device Inside/Outside) Ex D (Protective system) FSA 15 ATEX 1658 X
 NFPA 69 compliant
 Flex tip design certified to prevent flame passage
 NFPA 69 12.2.4.3.6 compliant



STANDARD FEATURES

- Explosion and flame isolation **up to 7 psi / 0.5 bar**
- 8 vane flex-tip NFPA 69** compliant rotor, Ex/flame proof
- 15 RPM, IP65** direct drive gear motor with flex coupling
- Inlet/ discharge size **20" X 20," 20" X 30" & 20" X 40"**
- Requires system integrated control panel for ATEX certification

OPTIONAL FEATURES

- Motors for hazardous locations and extreme temperature
- 30 RPM** gear motor with EM variable speed control package
- EM system integration package required for ATEX certification
- Stainless steel construction, Insulation box, speed monitor, flange gasket

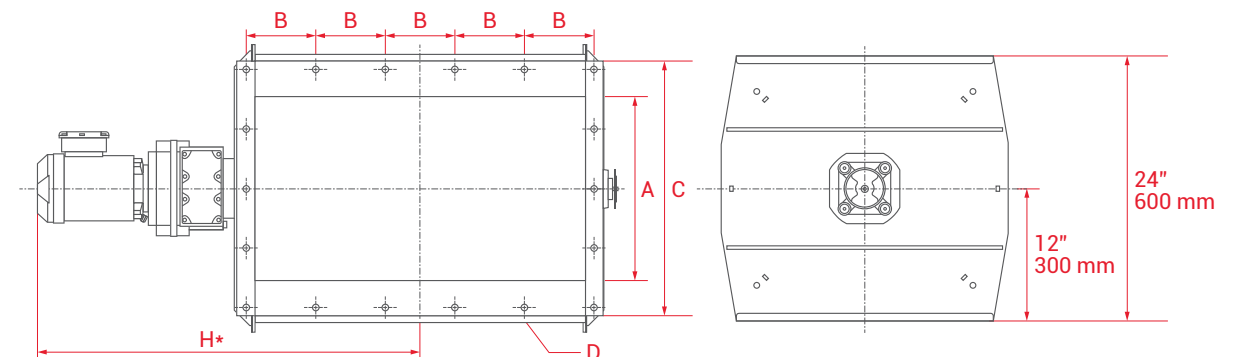

DIMENSIONS *								
MODEL	15 RPM HP	30 RPM HP	CAPACITY FT ³ (LTR)	A	B	C	D	H
EMVDL RVEX-BS500	1.00	2.00	4.41 (125)/rev	20" x 20" (500 x 500 mm)	0.16" x 5.30" (4 x 135 mm)	23" x 23" (580 x 580 mm)	16 x Ø 10.5 mm	30" (742 mm)
EMVDL RVEX-BS750	1.00	2.00	6.64 (188)/rev	20" x 30" (500 x 750 mm)	0.20" x 6.22" (5 x 158 mm)	23" x 33" (580 x 830 mm)	18 x Ø 10.5 mm	34" (867 mm)
EMVDL RVEX-BS1000	1.50	3.00	8.83 (250)/rev	20" x 40" (500 x 1000 mm)	0.31" x 5.12" (8 x 130 mm)	23" x 43" (580 x 1080 mm)	24 x Ø 10.5 mm	40" (997 mm)

Available as EMVDL-RVEX-BS, Rotary valve with explosion detector and control – Available as EMVDL-RV-BS, Rotary valve only

* Length varies dependent on motor selection – Units in inches rounded to the closest whole number

Rotary Valve VDL-HTHB (Heat resistant)

APPLICATIONS

- Rotary airlock for dust collectors and cyclones
- Feeder valve for screw conveyors, scales, dryers and coolers
- Rotary valve is suitable for ambient temperature up to 104°F/40°C
- Suitable for product temperatures up to 392°F/200°C
- Differential pressures up to 40" WG / 1.000 mm w.g.

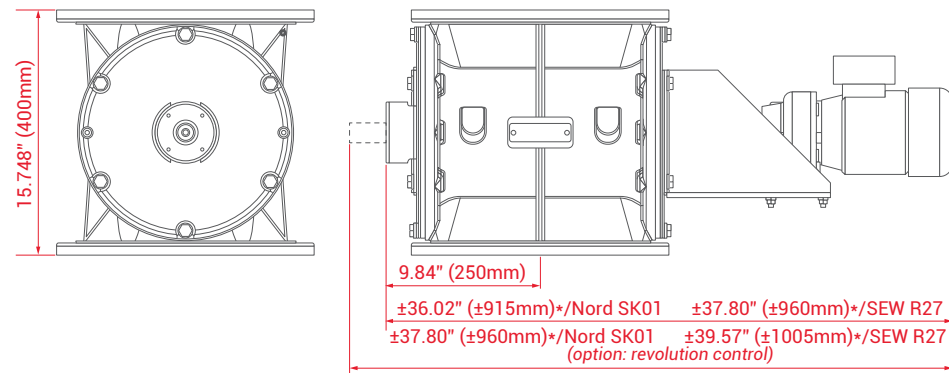
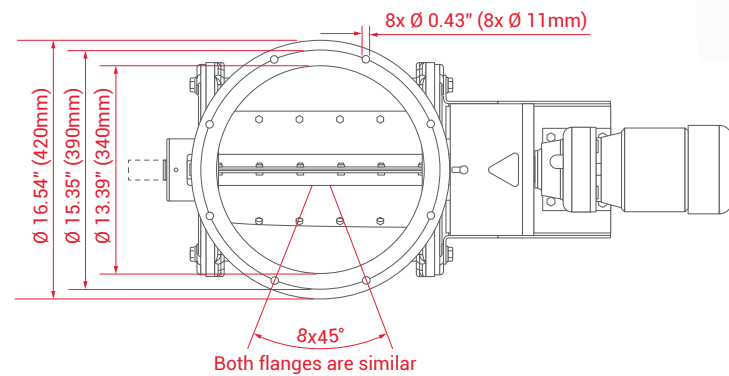

* Length varies dependent on motor selection

	VDL-HTHB-250	VDL-HTHB-350
Body and covers	Cast iron GG25	
Inlet and outlet	10" / 250 mm	14" / 350 mm
Rotor construction	Open, with 6 chambers	
Drive unit	Direct, with chain coupling and gearmotor HTHB 250 : 0,33 HP (15 RPM) - 0.50 HP (30 RPM)	Direct, with chain coupling and gearmotor HTHB 350 : 0,50 HP (15 RPM) - 1.00 HP (30 RPM)
Finishing	<ul style="list-style-type: none"> In- and outlet painted in heat resistant, silver paint Body, covers and motor console painted in heat resistant, silver paint 	
Sealing	<ul style="list-style-type: none"> Bronze bush Rotor with 6 chambers : Bronze bush + heat resistant sealing + heat resistant feltring 	
Bearings	Slide bearings with PTFE coating	
Max. operating pressure	20" w.g. / 5.000 Pa	
Temperature	5°F up to 392°F / -15° up to 200°C	
Capacity (100% filling)	0,23 FT³ (7 liters) / rev	0,70 FT³ (20 liters) / rev



ROTORS



INSULATION

Rotary Valve VDL-HTHBS (Heat resistant)

APPLICATIONS

- Ideal for dust collectors, cyclones, silos, hoppers & specialized process applications
- Rotary valve is suitable for ambient temperature up to 104°F/40°C
- Suitable for product temperatures up to 392°F/200°C
- Tested for high vacuum applications up to 160" WG / 4.064 mm w.g.
- Rotor selections for dry, corrosive & sticky material

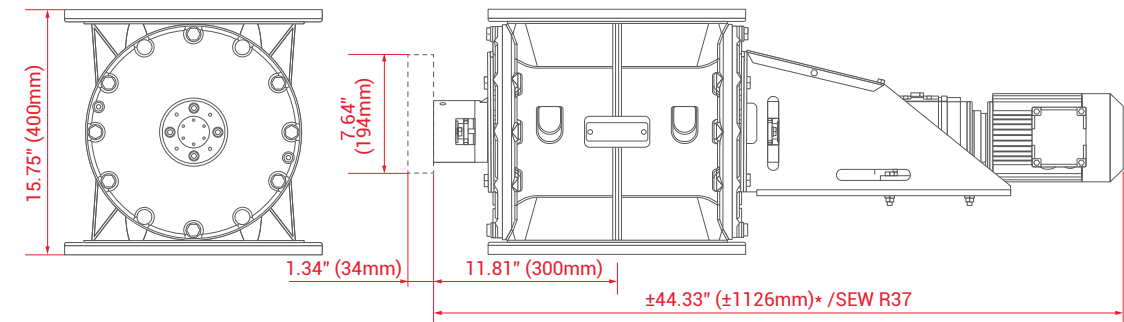
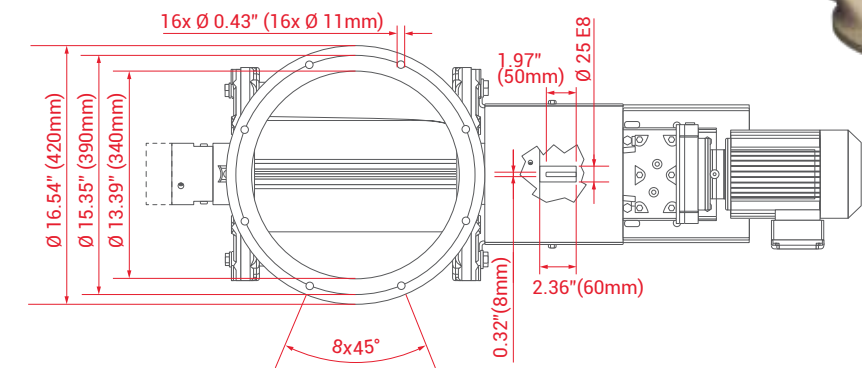

* Length varies dependent on motor selection

	VDL-HTHBS-250	VDL-HTHBS-350
Body and covers	Cast iron GG25	
In- and outlet	10" / 250 mm	14" / 350 mm
Rotor construction	Open, with 8 chambers	
Drive unit	Direct, with chain coupling and gearmotor HTSHB 250 : 0,33 HP (15 RPM) - 0.50 HP (30 RPM)	Direct, with chain coupling and gearmotor HTSHB 350 : 0,50 HP (15 RPM) - 1.00 HP (30 RPM)
Finishing	<ul style="list-style-type: none"> In- and outlet painted in heat resistant, silver paint Body, covers and motor console painted in heat resistant, silver paint 	
Sealing	Adjustable gland packing	
Bearings	External heat resistant ball bearings	
Max. operating pressure	157" w.g. / 40.000 Pa	
Temperature	5°F up to 392°F / -15° up to 200°C	
Capacity (100% filling)	0,23 FT³ (7 liters) / rev	0,70 FT³ (20 liters) / rev



ROTORS



INSULATION

Rotary Valve Blades & Rotors

EcoMAXX® Rotary Valves are available with a wide range of replaceable blades and optional rotor styles to handle just about any application.

Product characteristics	BLADE MATERIAL			
	Polyurethane	Steel	Stainless Steel	
POWDERS	Not abrasive	X	X	X
	Abrasive	X		
	Sticky		X	X
	Corrosive			X
GRANULATES	X			
FIBROUS MATERIAL	X			



HT Stainless steel
Stainless steel removable blades
6 or 8 vanes



MD Steel
Polyurethane removable blades
6 or 8 vanes

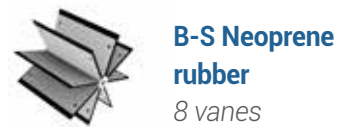

B-S Neoprene rubber
8 vanes



HT Stainless steel
Polyurethane removable blades
6 or 8 vanes



MD Steel-Steel
Removable Tips
6 or 8 vanes



B-S Silicone
8 vanes



HT Steel-Springsteel
Removable blades
6 or 8 vanes



MD Stainless steel
Fixed blades
all around tapered
6 or 8 vanes



B-S
8 vanes



HT Steel
Polyurethane removable blades
6 or 8 vanes



MD200 Stainless steel
Removable stainless steel blades
6 or 8 vanes



MD Steel
Fixed steel blades
welded and tapered
6 or 8 vanes

Rotary Valve Accessories

Boss Products knows that the right rotary valve can be key range of accessories for use with our rotary valves to meet to a successful project. EcoMAXX® VDL offers a complete all of your special application needs.

Pneumatic Convey Line Injectors

Used to introduce metered product from the airlock into a pneumatic airstream. Stainless Steel construction available in diameters 2 3/8"-6".



Tube diameter in. (mm.)	MODEL			
	MD 150	MD 200	MD 250	MD 300
2 3/8 (60)	X			
3.0 (76)	X			
3.5 (88,9)	X	X		
4.0 (101,6)		X	X	
4 1/4 (108)		X	X	
4.5 (114,3)			X	X
5.5 (139,7)				X
6.0 (154)				X

Insulation Boxes

Insulation boxes are available for applications requiring operation in extreme heat or cold conditions.

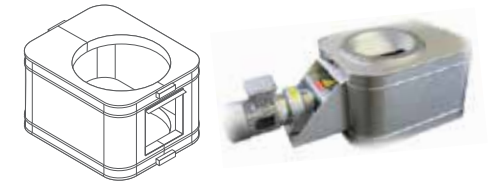

Replacement Gaskets in EPDM & Silicone

Factory cut precision gasketing is available in EPDM or Silicone



Special Sanitary designs

Special designs are available for applications that require quick and deep cleaning.



Speed Sensors

Detects rotor RPM for speed control

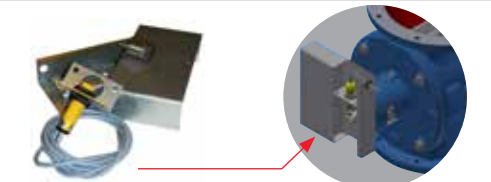

Capacity Limiter w PU Blade

Prevents the overfilling of the rotor chamber. Helps prevent product damage.

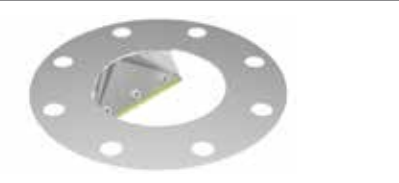

Air Purge Seal Kit

Creates an overpressure which keeps abrasive powders out of bearings & seals.

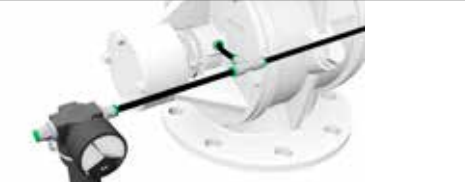



Transitioning the World to a Safer Working Environment



ISO 9001 : 2015 Certified Company, Certificate #12373



RAPTOR Series™



6729 GUADA COMA DR. - SCHERTZ, TX 78154 -USA - Main # 210-664-4200

info@bossproductsamerica.com